

UPCYCLED PAPER WREATHS

SUPPLIES

- Toilet paper rolls
- Plain Paper
- Hot glue gun
- Scissor
- Gold ring
- Wooden spheres

INSTRUCTIONS

1. Cut the first toilet paper roll in half, length-wise.
2. Cut two pieces of paper. They should both be the same length as your paper towel roll half. One should be about half the height. The second should be about two centimeters taller. Fold both these papers in half length-wise. Fold the toilet paper roll halves from the previous step in half length-wise as well.
3. To assemble the flower petals, first glue one long edge of the shorter paper to the inside long-edge of the toilet paper roll half.

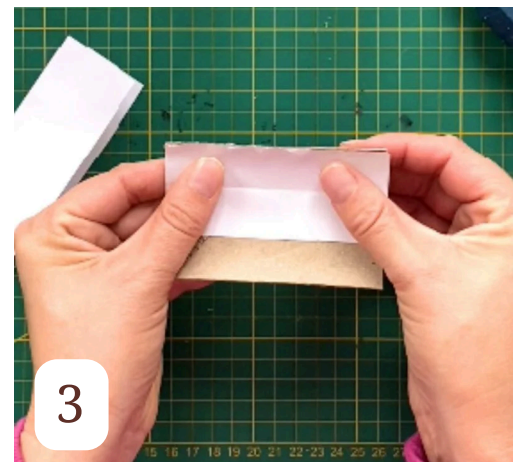
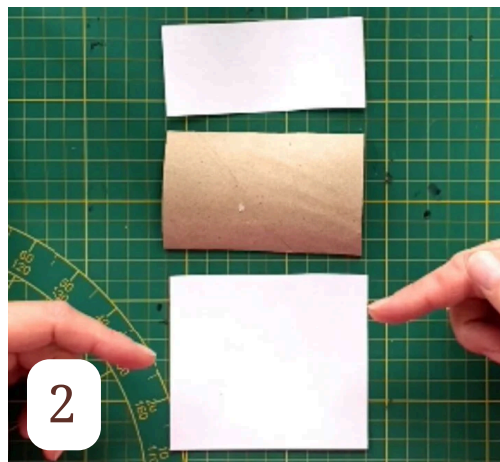
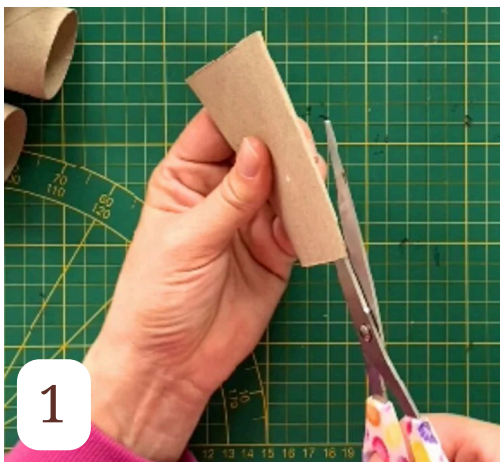

UPCYCLED PAPER WREATHS

INSTRUCTIONS (CONTINUED)

4. Glue the other edge of the paper down to the same area. The small paper should now be “closed.”
5. Glue the other edge of the toilet paper roll half down so that it is also closed.
6. In a similar fashion, glue the edge of the toilet paper roll half (where we glued the paper on the inside) along the bottom of the larger paper.
7. Wrap the paper around the folded toilet paper roll half and glue on the opposite edge.
8. Once the glue has dried, cut this piece into strips about a centimeter long each. These are now the flower petals, each one held together along the edge we glued in the previous steps.
9. Repeat steps 1-8 on 2-3 more paper towel rolls.
10. To create the flowers, glue 8-10 petals together only along the glued edges. It is suggested to glue 2-3 petals together at a time. Then these smaller groups can be glued together to form the flower.

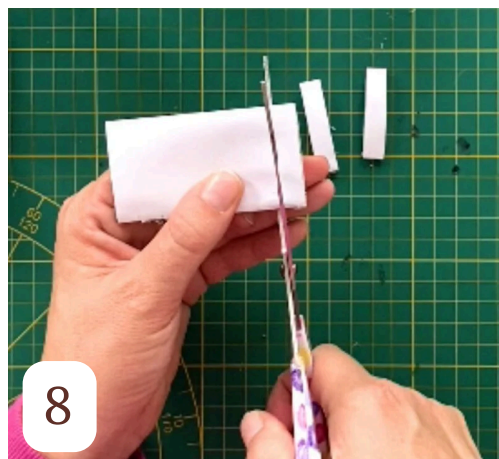

UPCYCLED PAPER WREATHS

INSTRUCTIONS (CONTINUED)

11. Glue a pom pom or wooden bead to the center of each flower.
12. To create the leaves, cut a paper in half length-wise, like in the step 1.
13. Fold each piece in half and glue along the two long edges.
14. Cut into 1 centimeter strips.
15. Glue two of these strips together at the bottom.
16. Repeat steps 12-15 until you have your desired amount of leaves. 8-10 is recommended.
17. Glue the flowers and leaves to the gold ring.
18. Tie a string or ribbon to the top of the ring. Your wreath is now finished and can be hung.

